

Passive Ventilation vents (windcatchers) lead hot and dry air into terracotta pipes, the end part is equipped with a patterned inner surface for maximum evaporation, the surface is saturated with water from roof what stormwater tank, to evaporating into the rooms cooling the air and humidifying it at once

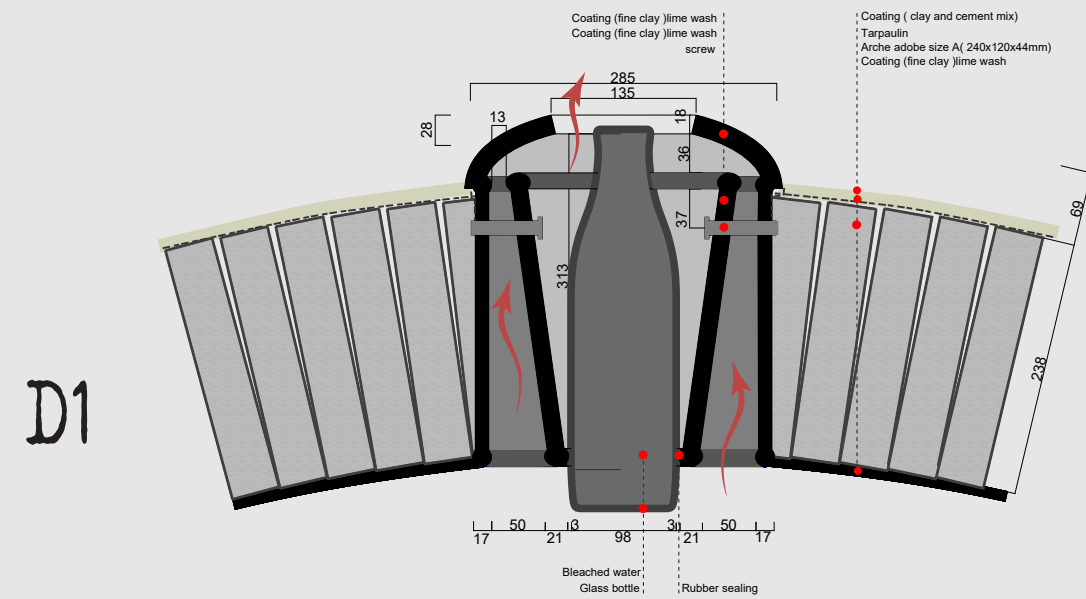

This low c solution for skylight (solar tube) is a placeholder for high-end one, the bleached water prevent modeling and scatter light more consistently,also this forms a protected outlet for hot air through the roof

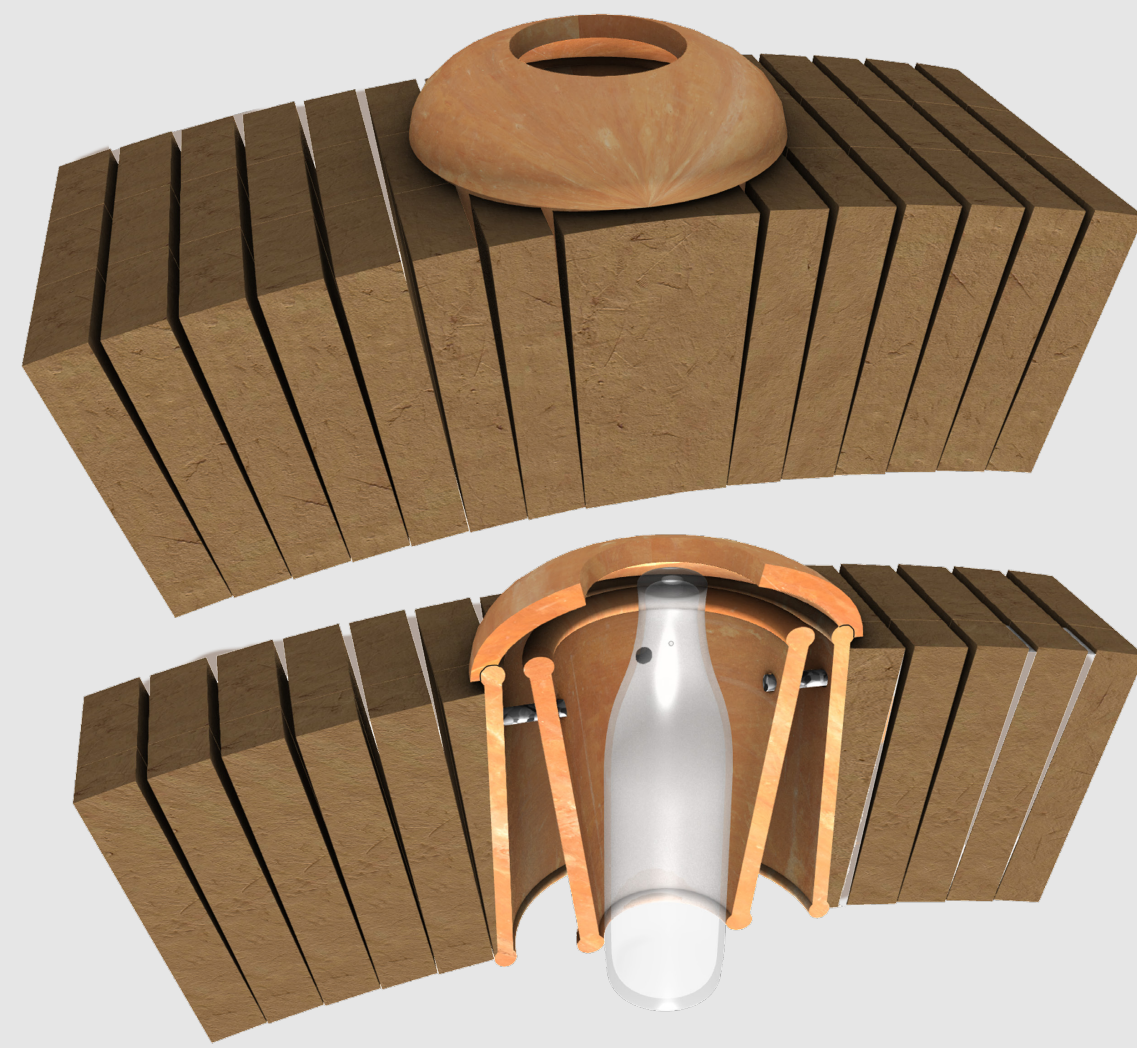
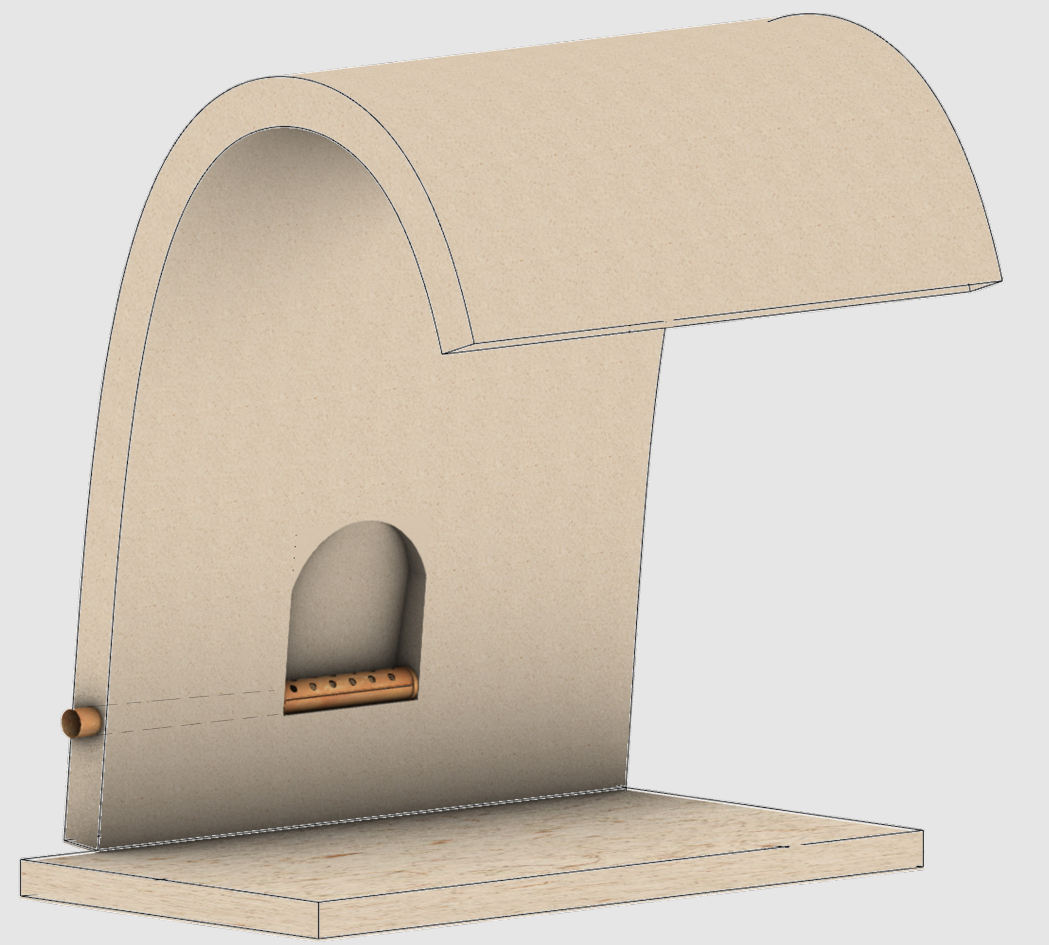
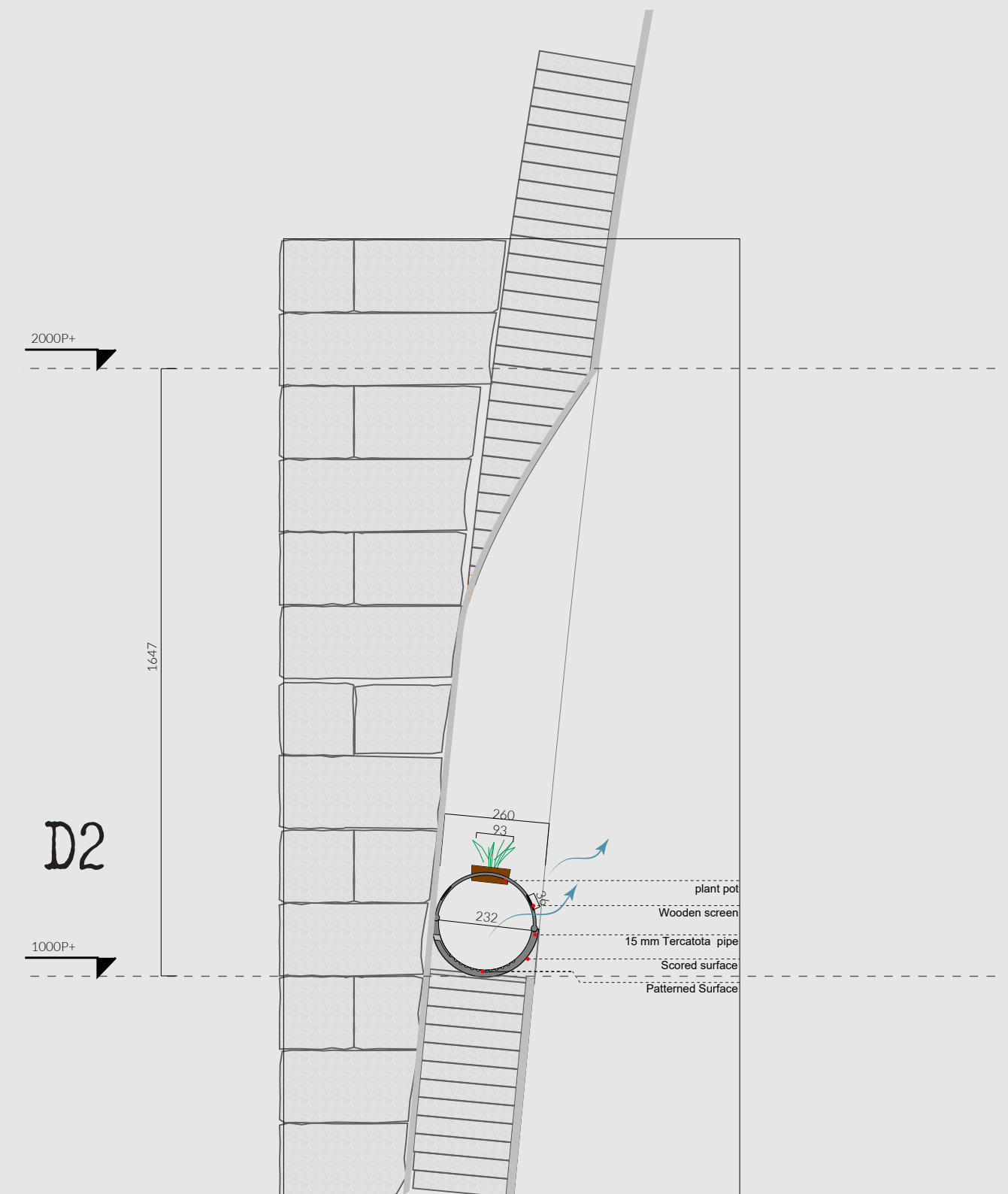

AI-Raqqa CIVIC GENERATOR



- Roof movment flow
- Escape routes
- External access to the roof

Polyculture farming
in contrast to
monocrop farming
reduce stress and
depletion of soil
and allows for over
the year use of the
soil, additionally
the multiple layers
of shading help
producing more
vulnerable crops
without losing water
for evaporation

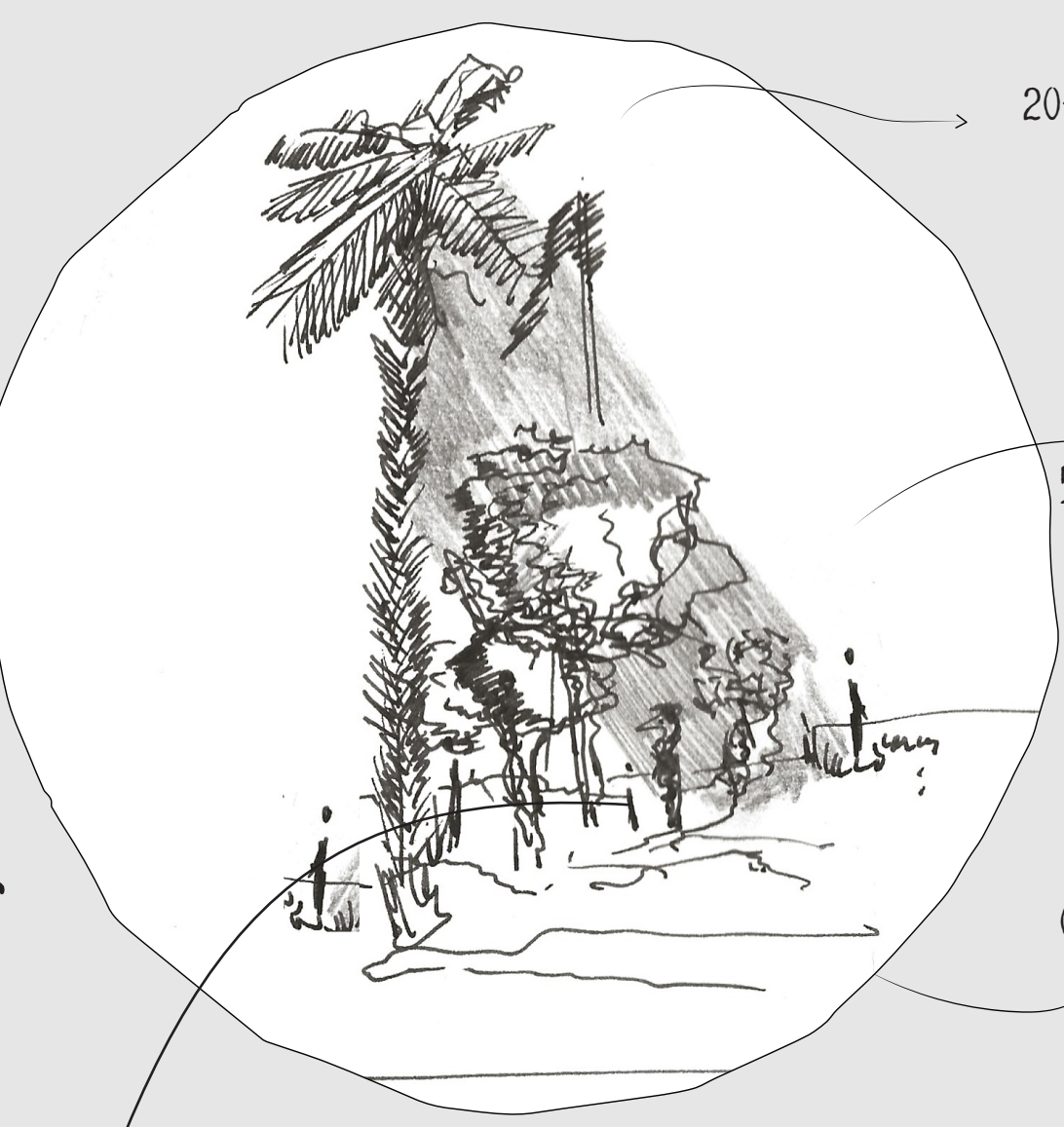

- 20-30 M
- 5-8 M
- 0.5-1.5M
- Date Palms
high tolerance for
heat and drought, cast
a shadow over less
tolerant short trees
- Orchard of less tolerant
tree
Olive trees
Genus Prunus (almonds ,
peach)
- shaded protected crops
Lagumes
Herbs , Roses



The color palette of the
buildings are driven from the
city close and far history



the public square and street tiles are
made by compressing the debris of the
site rubbles, resulting in unique and
various colors from the different
parts of destroyed buildings
the Voronoi arrangement of the tiles
is a practical way to use the avail-
able material regardless of form and
shape, it can be seen as a link to the
imagery of the dry land in a new per-
spective

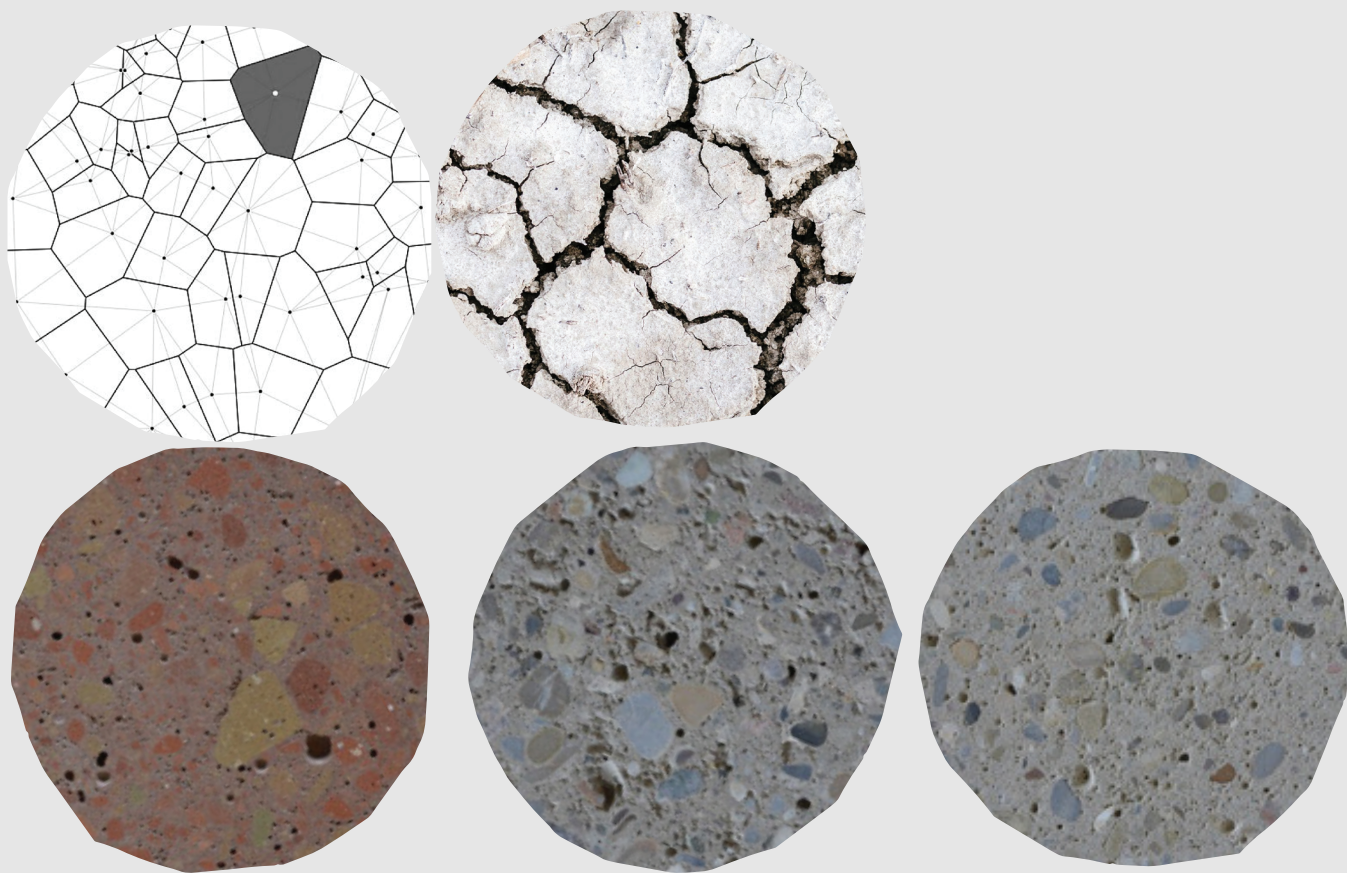

Reuse the unrecycled remains
of the rubbles in swamp part to
create the new landscape

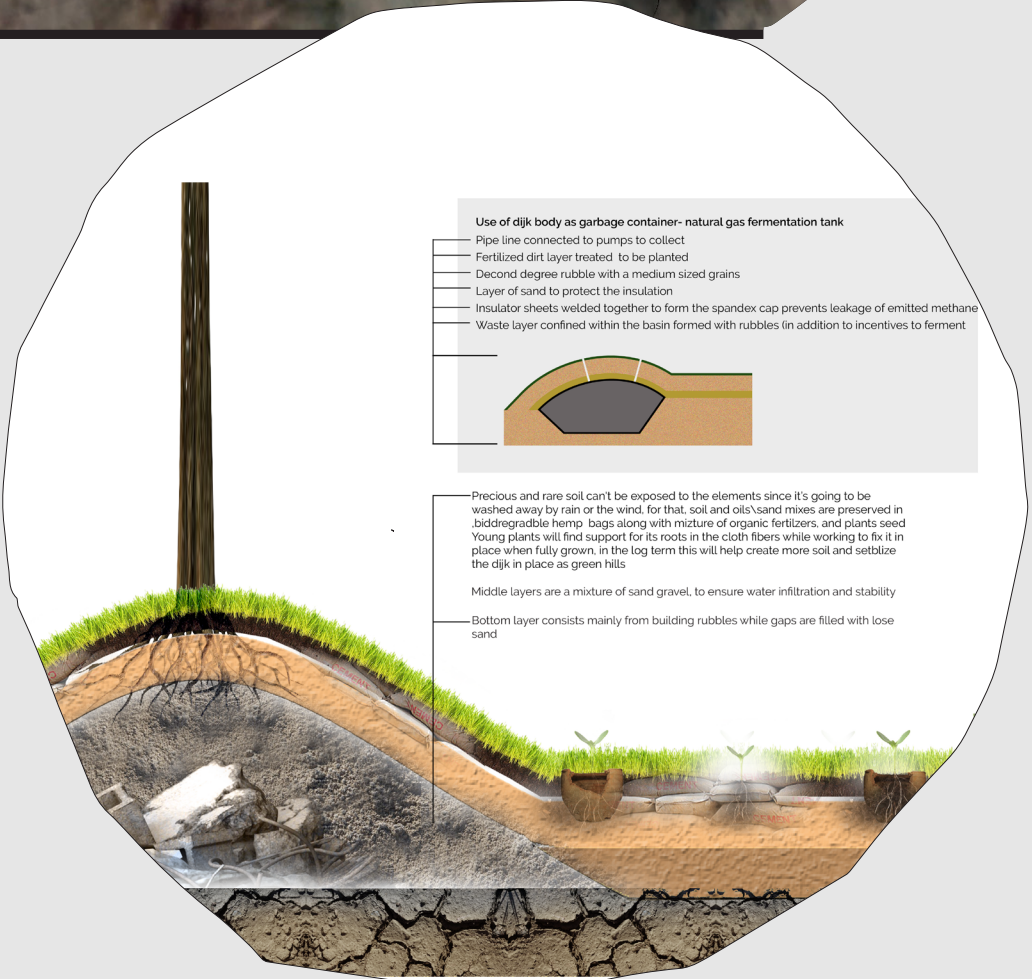

AI-Raqqa CIVIC GENERATOR

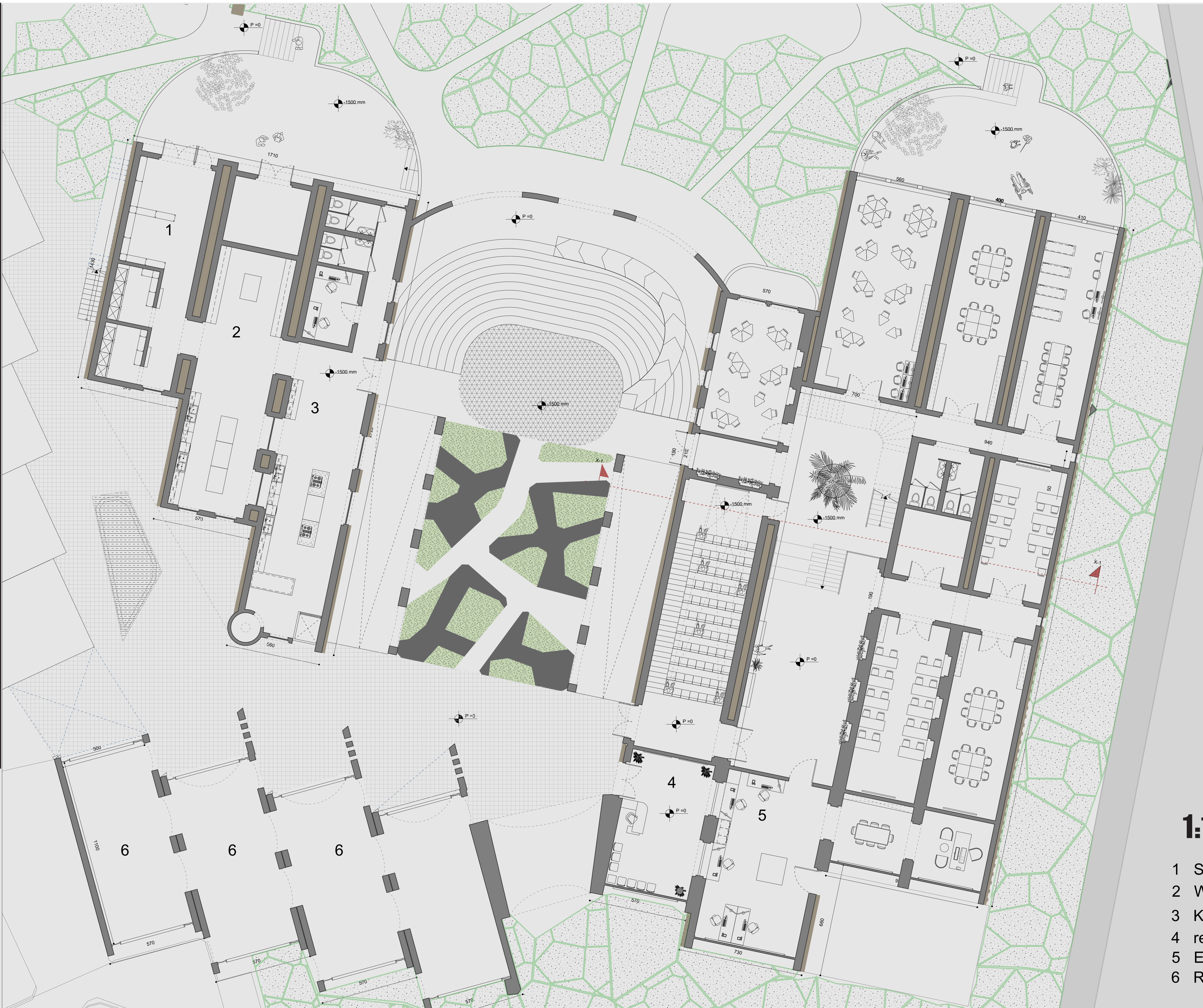

1:100

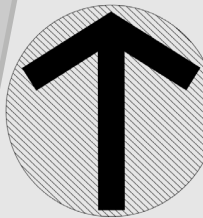

- 1 Storage / cold room
- 2 Wrapping
- 3 Kitchen
- 4 reception
- 5 Employees
- 6 Restaurant café

Al-Raqqa CIVIC GENERATOR

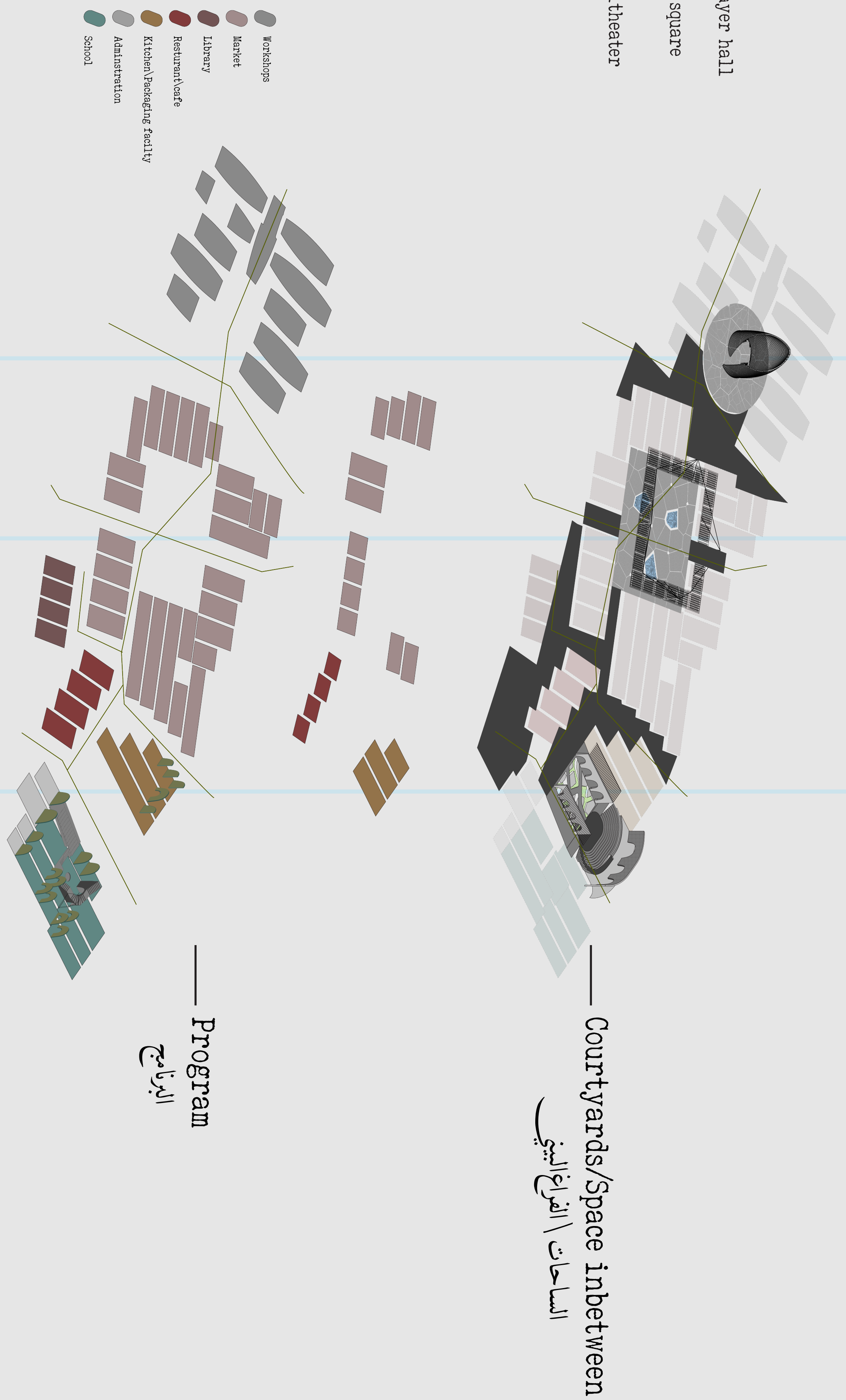
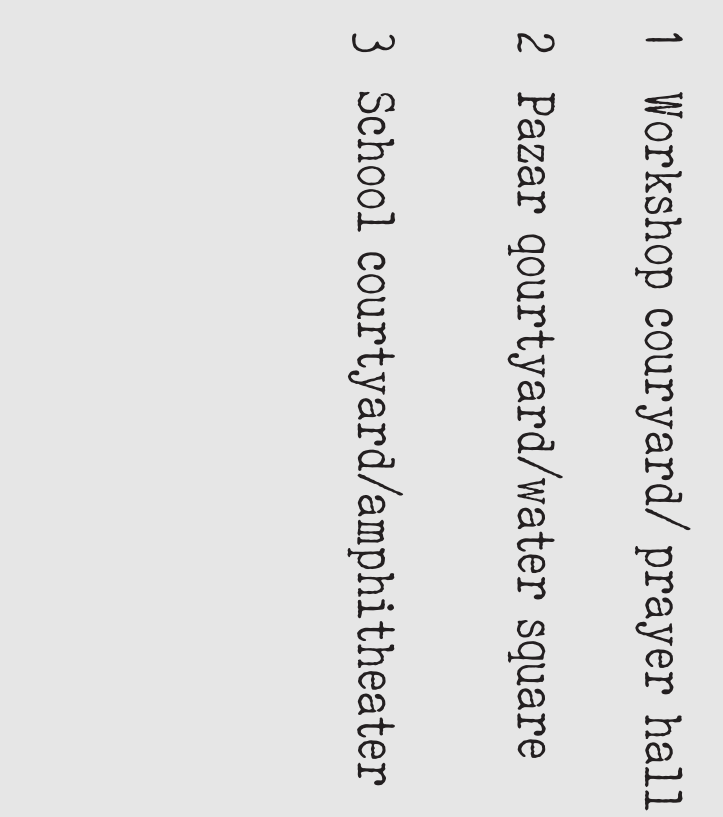
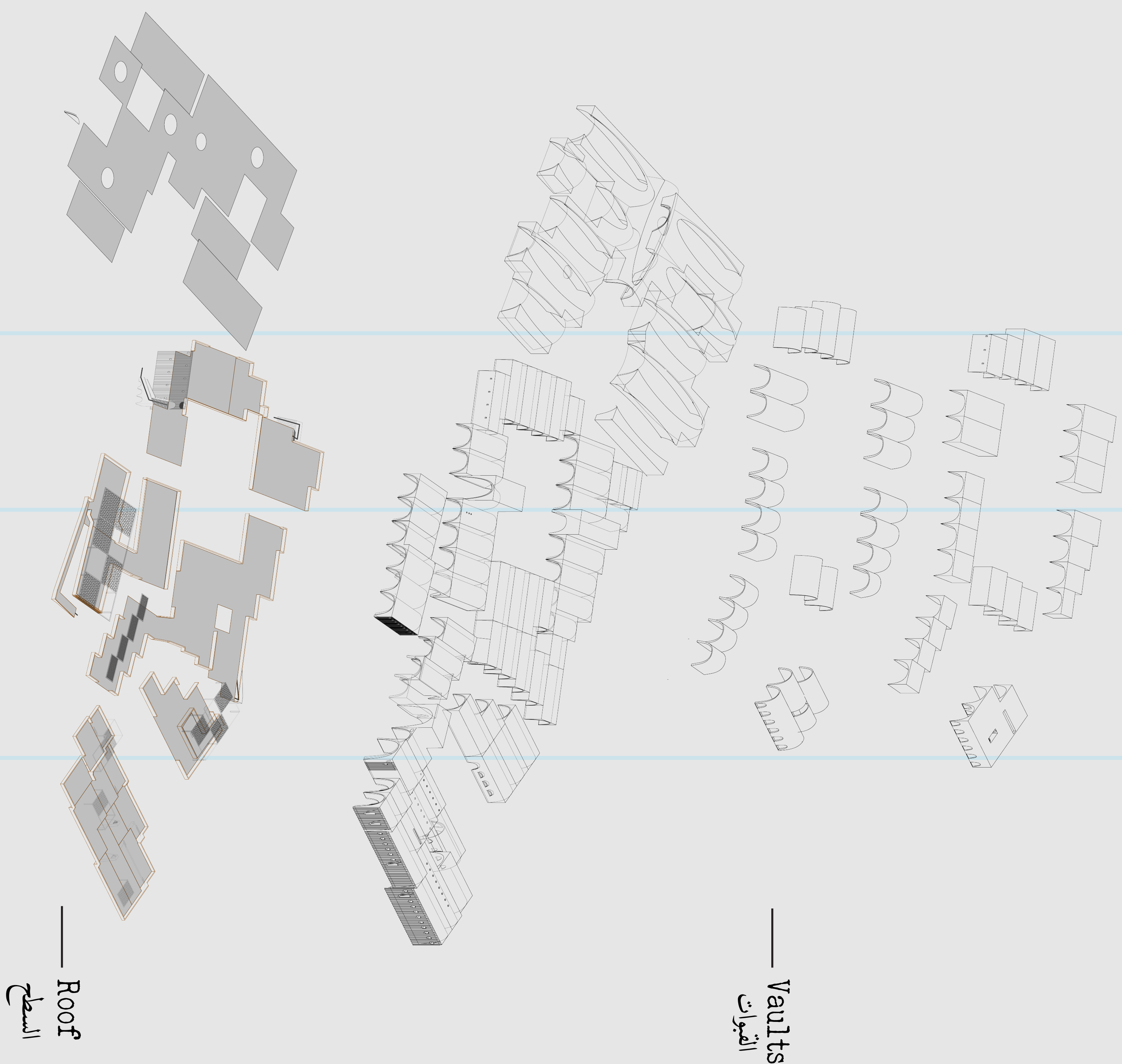

remaining basements of the old building, (under the squares) is used now for new functions, middle square as for water storage, the eastern building basement as an underground bomb shelter

Urban Condition

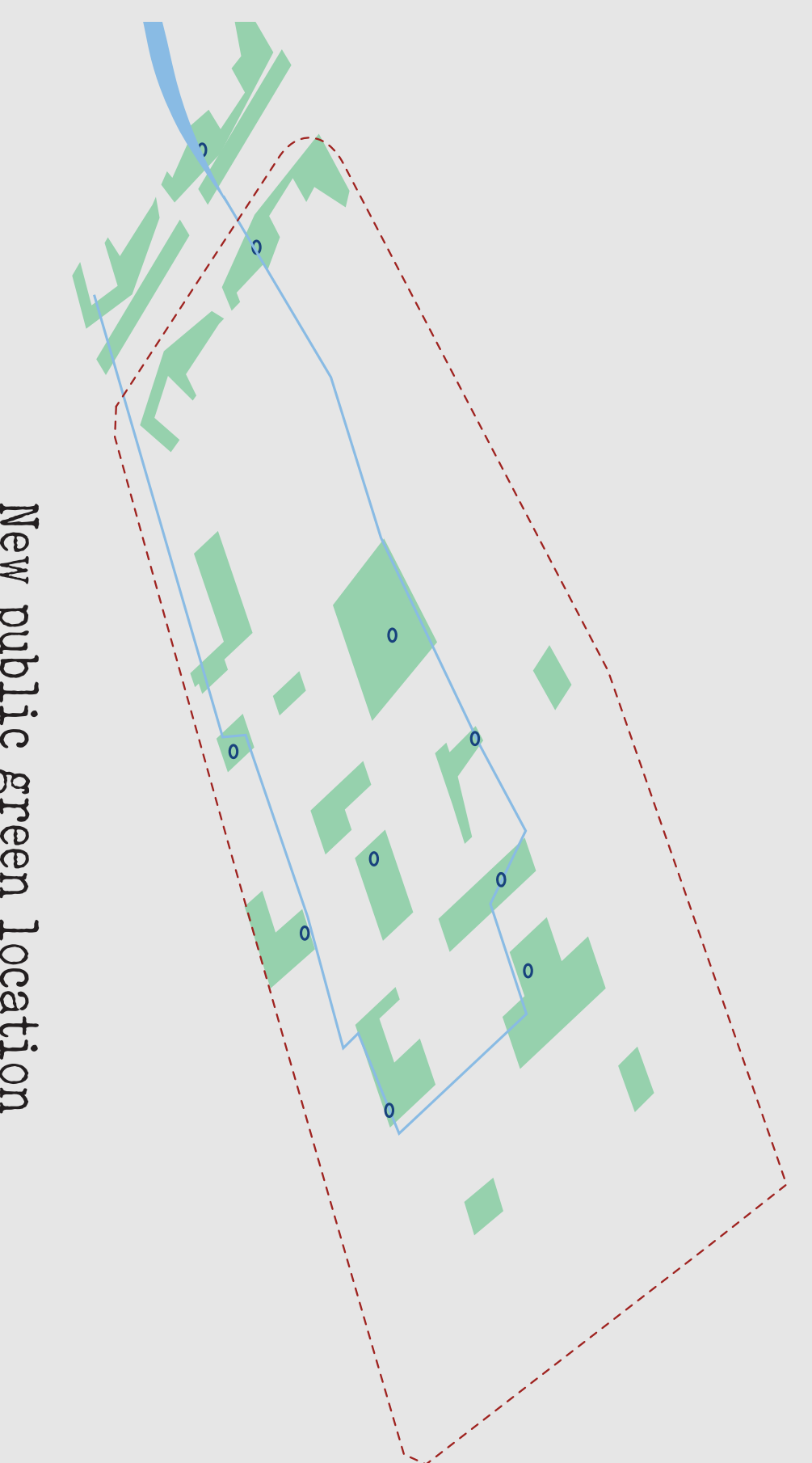
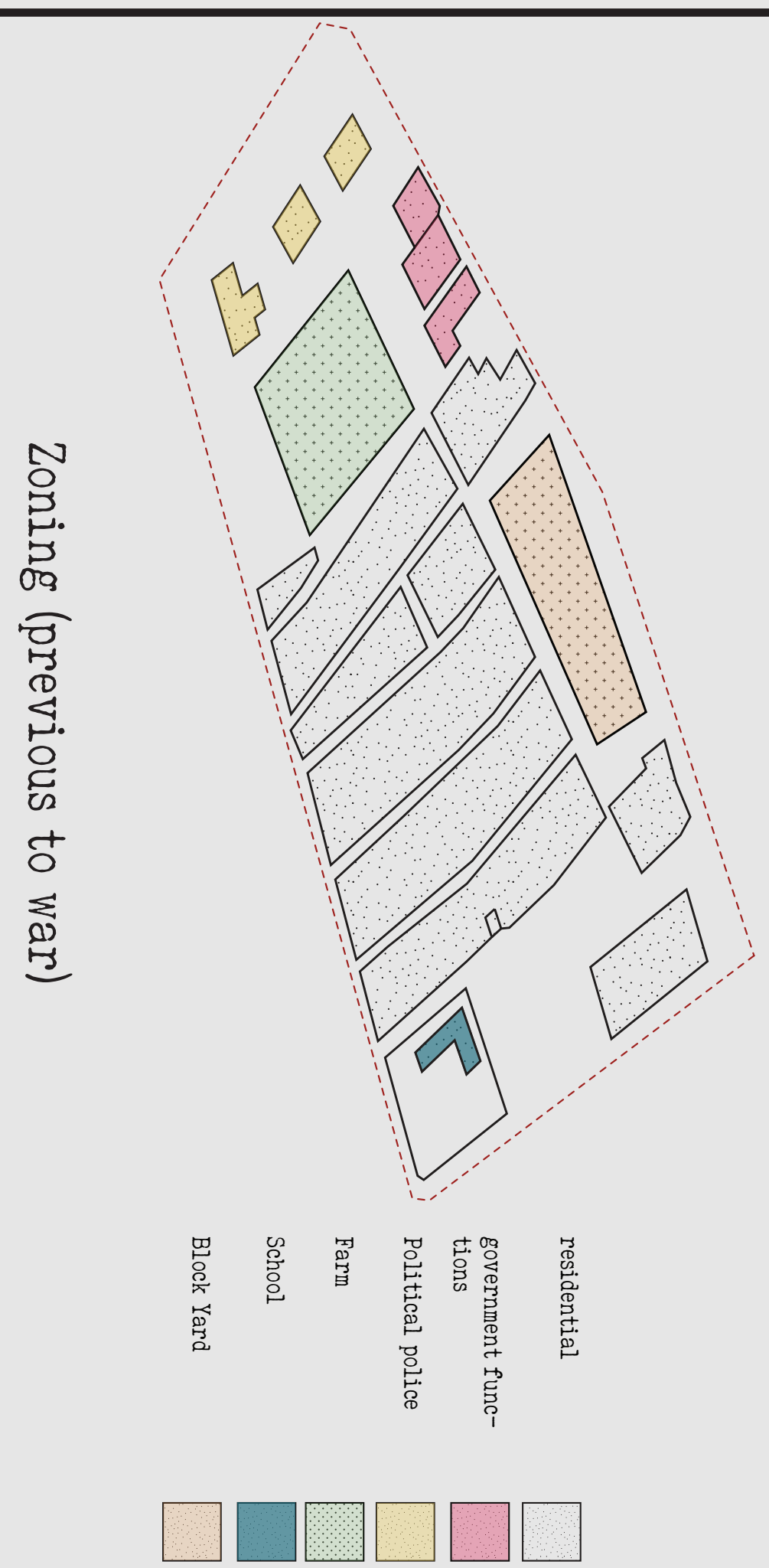

Urban Intervention

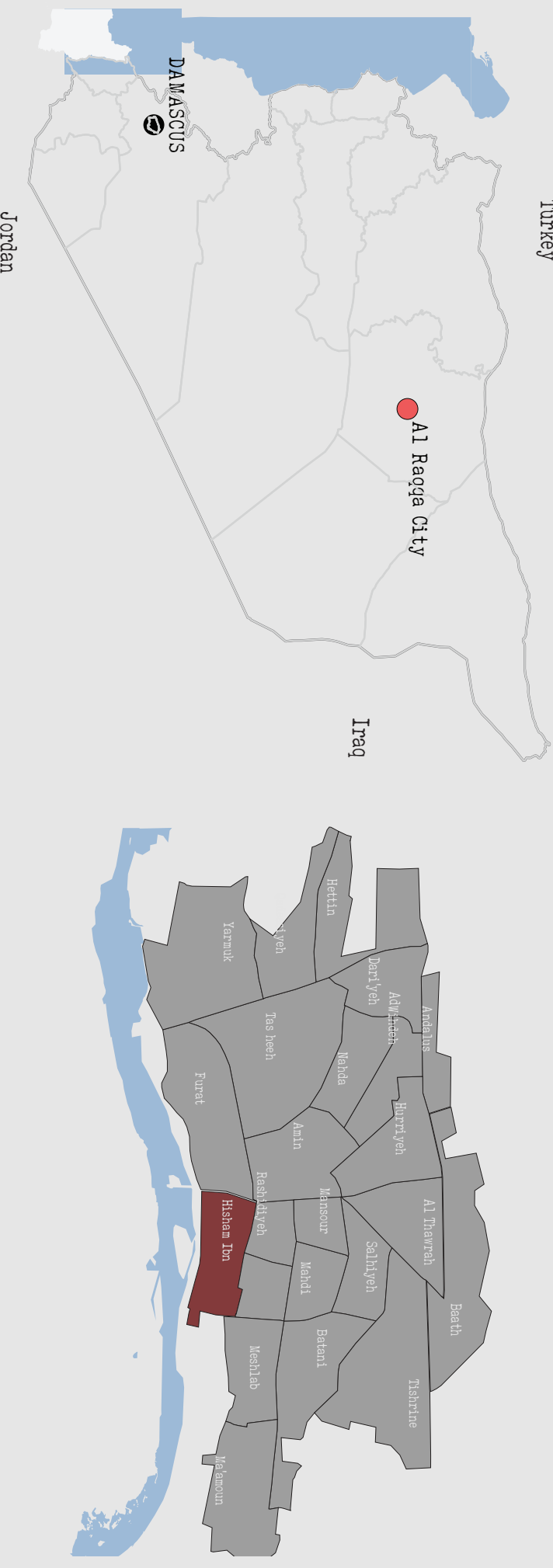
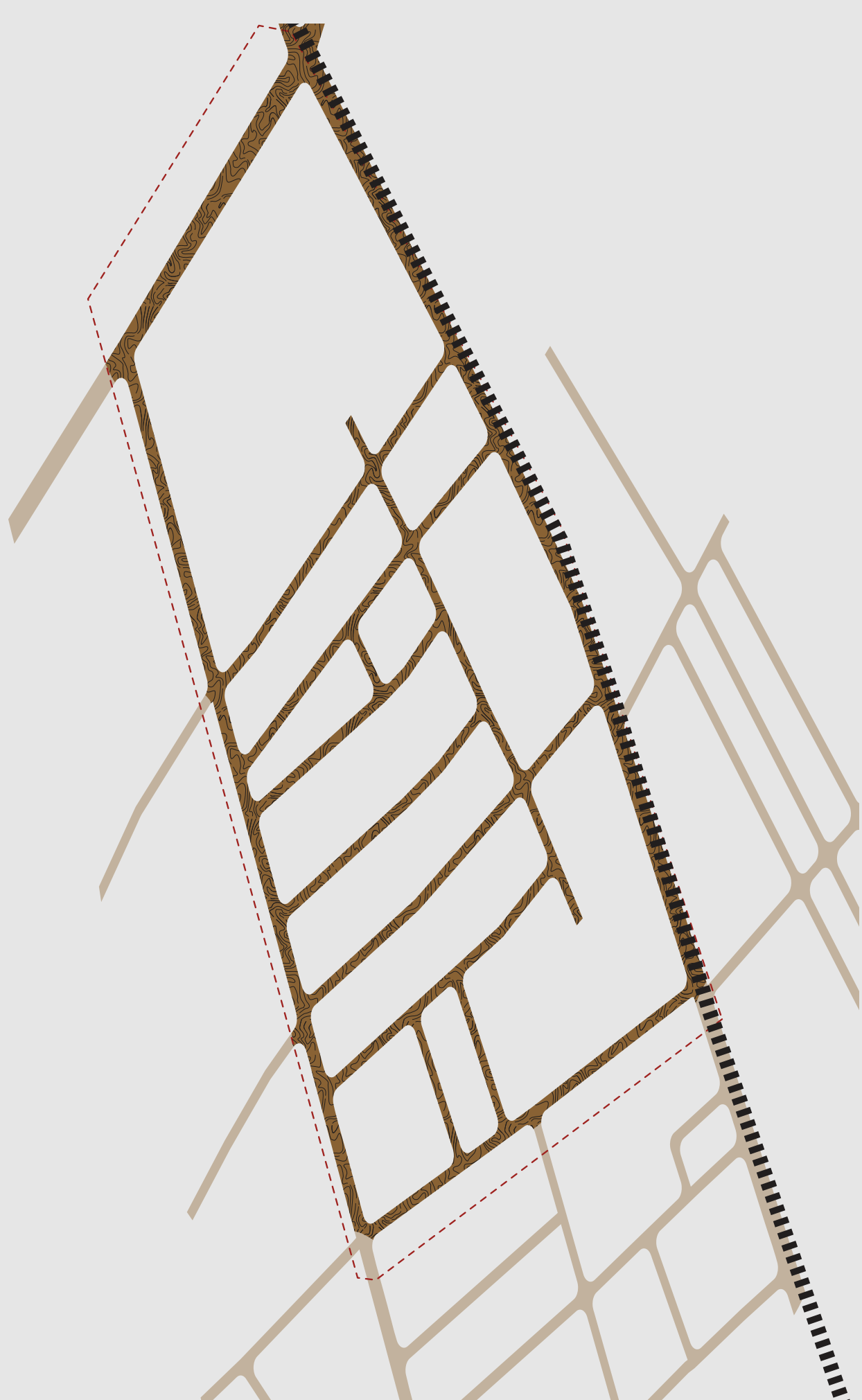
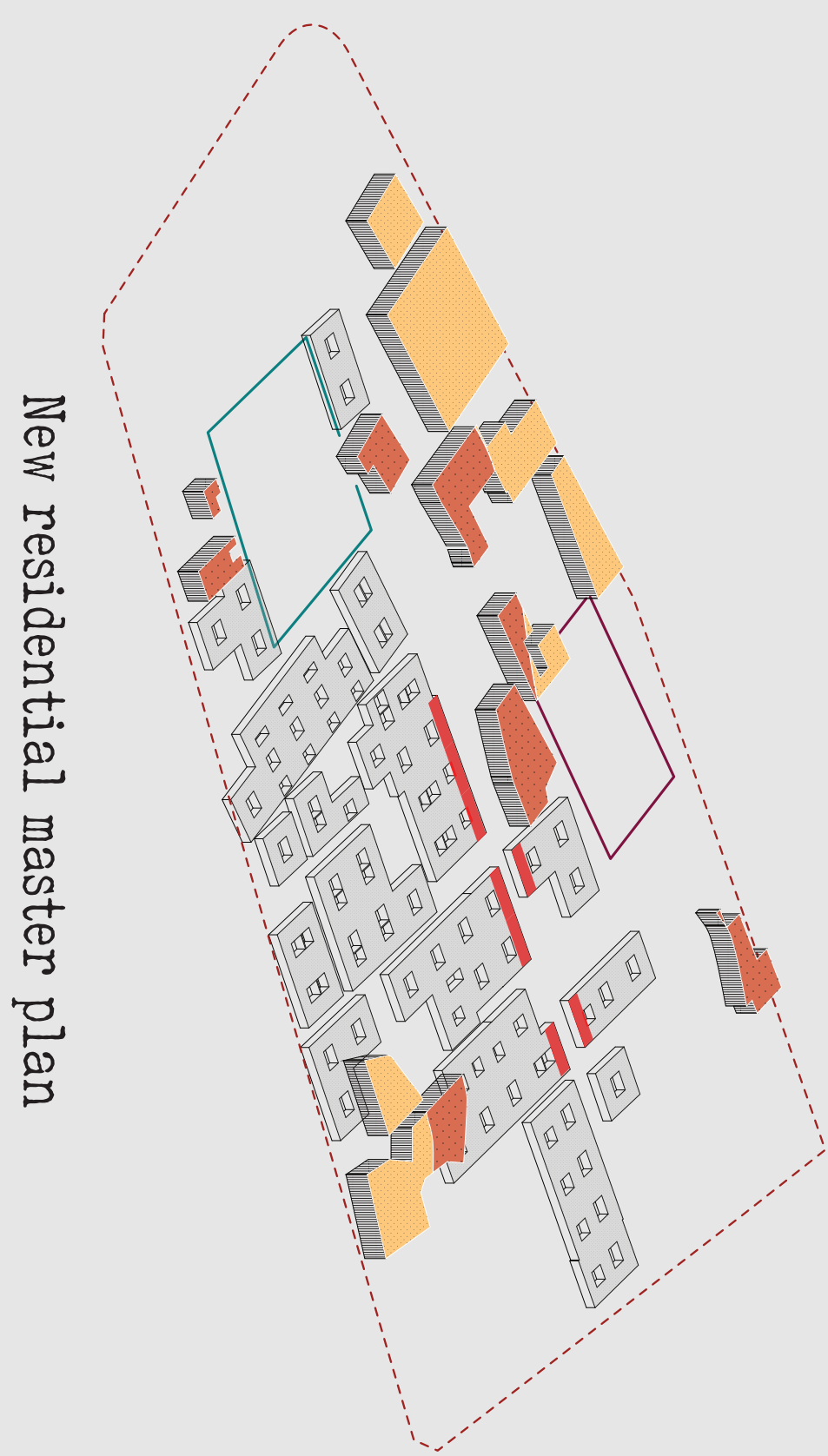
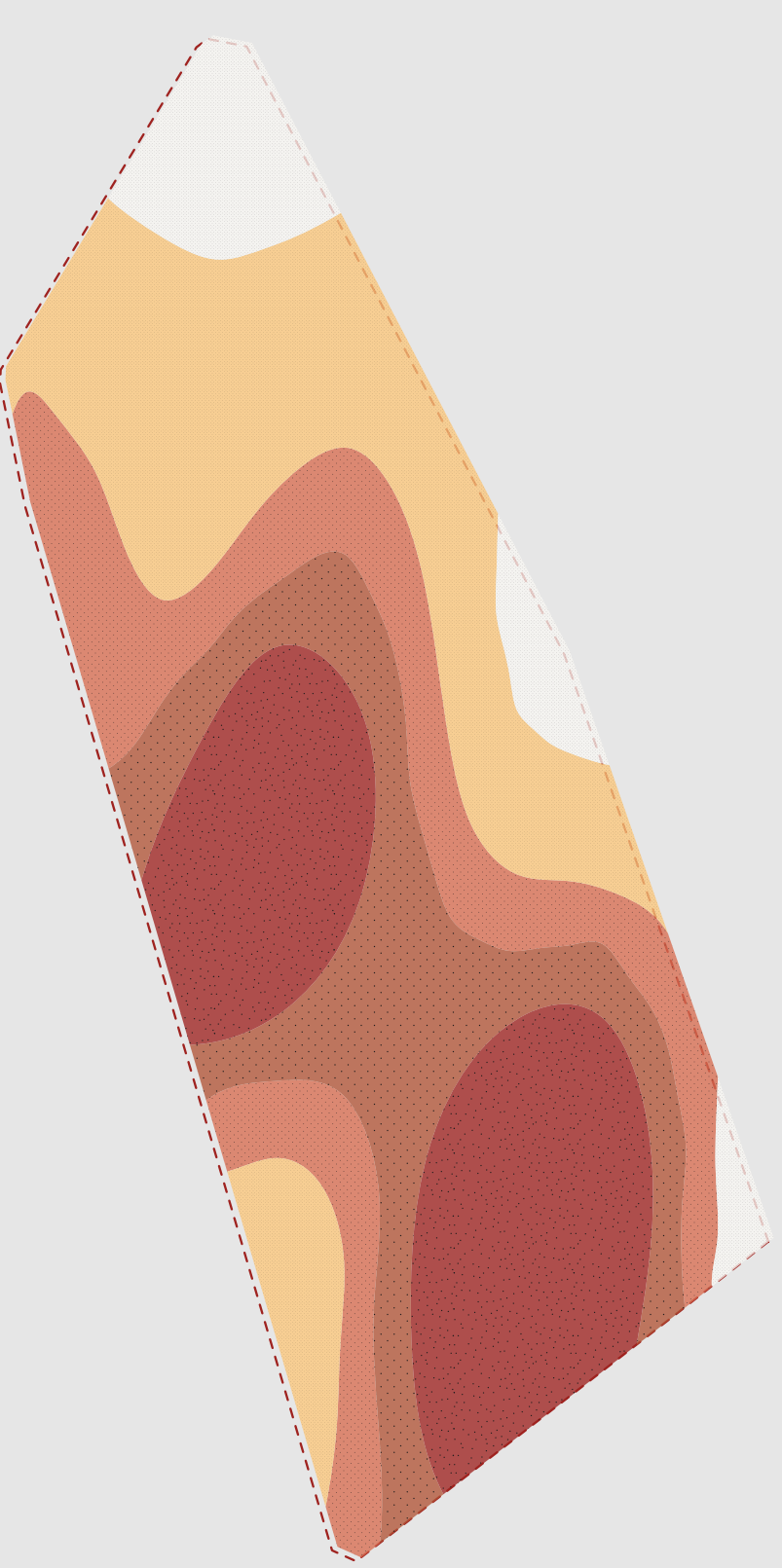
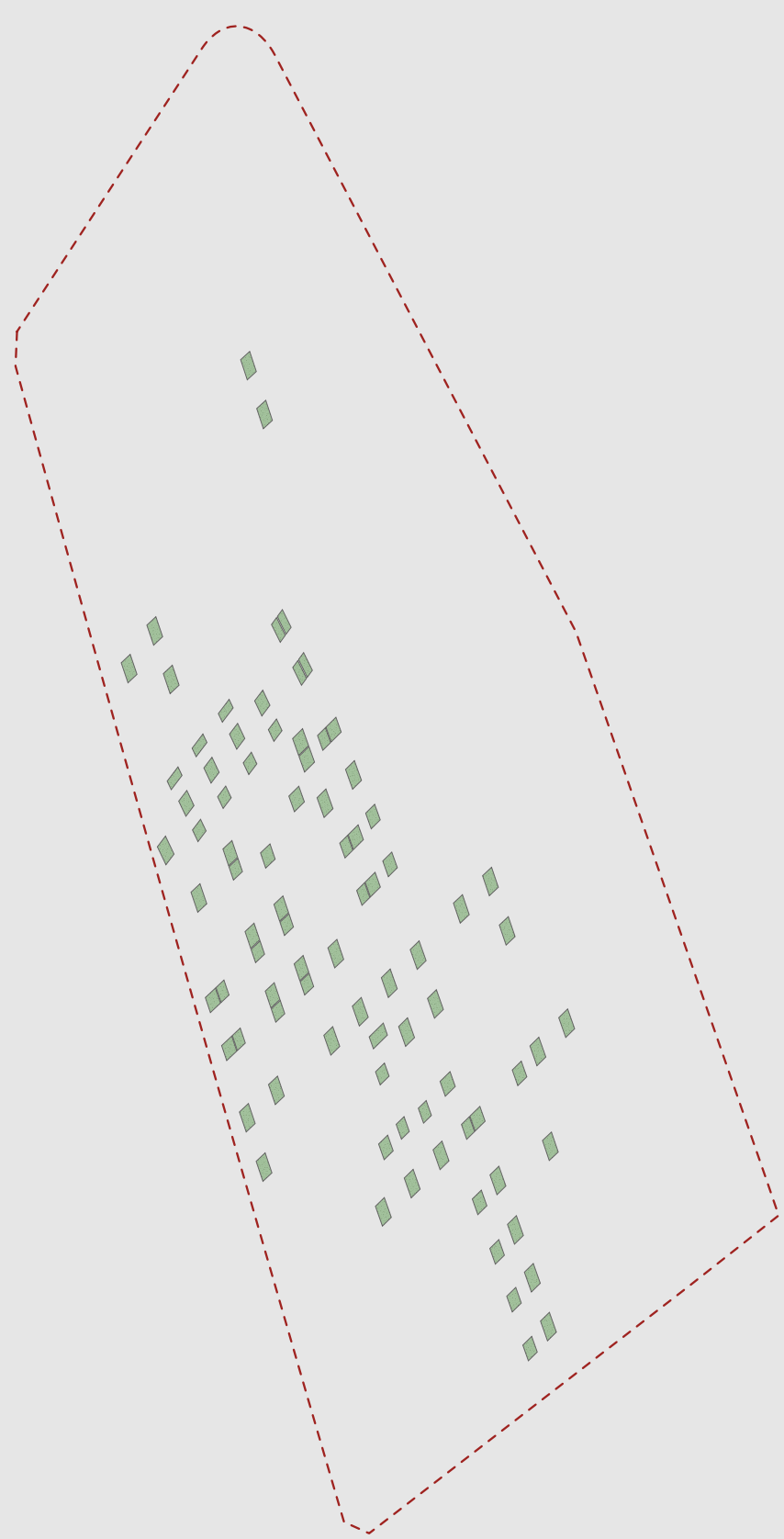
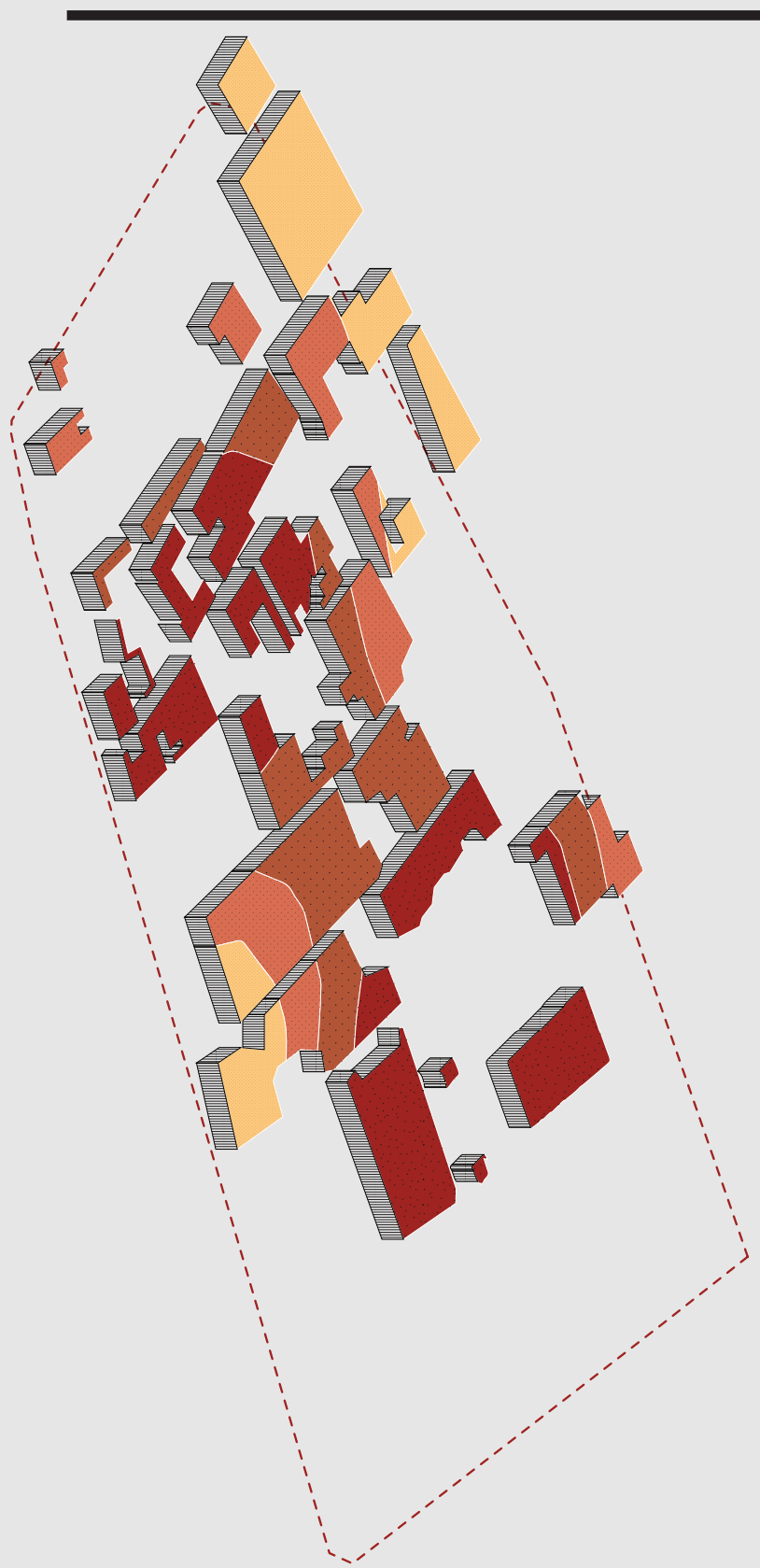
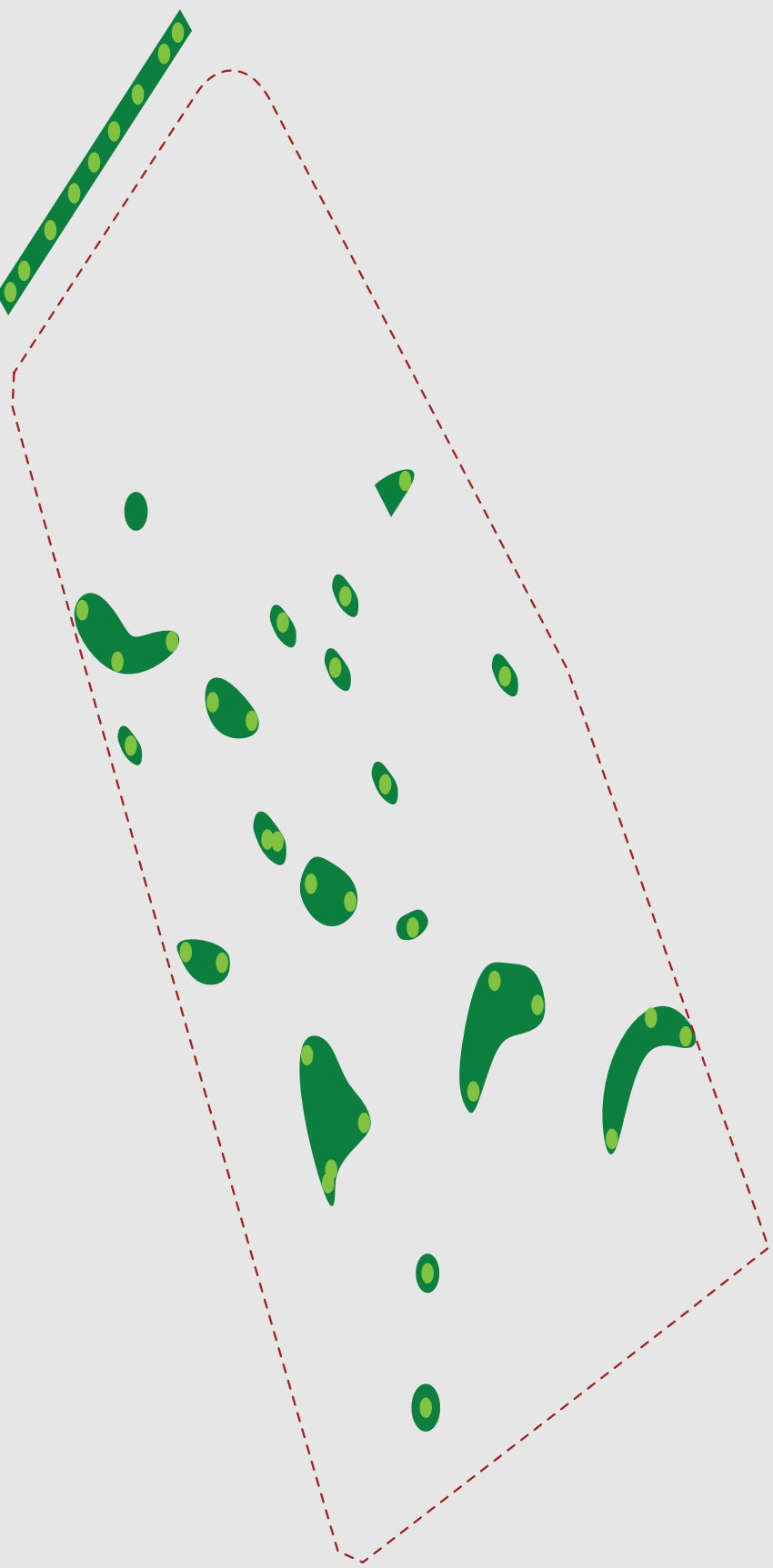

ACT I

Clearing out the rubble as the first step. Circa 20,000 people have returned to Raqqa now (80% of the total pre-war population) and are trying individually, or in small groups to clear out the rubble and secure shelters at the location of their old houses.

CLEANUP



OCCUPY

Residents of the first camps at the site will participate collectively in building the first vaults, only to move to it then and have a few waves of people in the tents, doubling the capacity of construction.

RECYCLE

Concrete rubbles are transferable into blocks to be used for foundations.



ACT II

Using this specifically designed wooden template, participants can quickly and accurately build extensive vaults with minimal skills and experience needed, allowing more people to participate,

BUILDUP



Compressed earth block using low tech block press can reduce their water content by over 90% in the brick compared to traditional hand molding resulting in way faster drying and more predictable results.

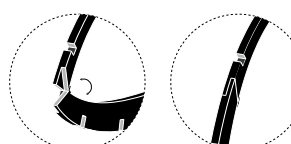
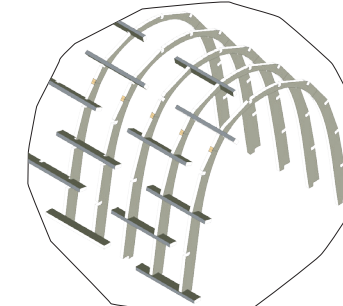
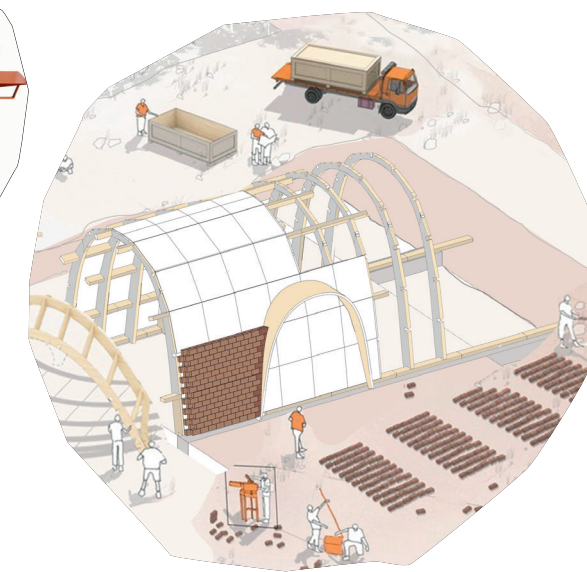

Only 3X unique elements to construct the template making it easy to reproduce with low tech tools available at the site

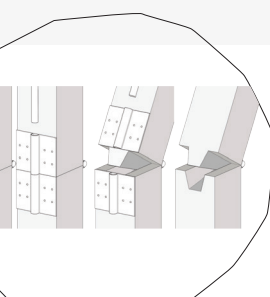

SIMPLE AND EFFECTIVE

The template is collapsible with easy low maintenance hinge to remove after locking the vault and reuse it to build the next one

ACT III

People are settled and rested in the building, plans to expand the operation toward the rebuilding the neighborhood are being shaped.

REUSE

The highly reinforced surviving basement of the previous buildings will be used for water storage under the square

PROTEST

Protests cannot be quarantined in these squares, as the escape routes can give a chance to scatter and regroup in the fortress-like building

ACT IV

People and moving back gradually to their houses (the rest of the block), the market hall activities are expanding

GROW YOUR FOOD

In between, places are used protected and shared spaces for social activism and urban gardening

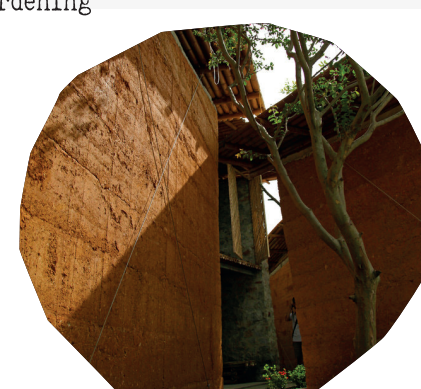

Residents grow their vegetables near the rubble -Aleppo, Syria April 22, 2016.

EXPRESS

All day shaded amphitheater is a place for public events and secession

ACT V

The Building is fully functional; residents have moved back to their restored homes, not this building is used for its public function(botanical school and training center)

TAKE A HIKE

Shaded pedestrian and bike paths along the street to promote physical activity

Ground floor on max capacity, building on top

Densifying, filling the gaps

Expanding building the workshops

the school is under construction, no more tents

more people are moving to the vaults

Refugees/volunteer camp building the first Vaults

